

CUSTOMER: _____

JOB NAME: _____

PO #: _____ QUOTE # _____

DATE: _____ QUANTITY: L _____ R _____

SHIP TO: _____

One Signature Required

PLUMBING CONTRACTOR APPROVAL _____ /_____/_____
DATE

GENERAL CONTRACTOR APPROVAL _____ /_____/_____
DATE

ENGINEER APPROVAL _____ /_____/_____
DATE

ARCHITECT APPROVAL _____ /_____/_____
DATE

To complete your order, this document must be signed and emailed to the Centralized Customer Service Center.
quotes@americanbathgroup.com • 800.443.7269

STANDARD FEATURES

- Pre-leveled base
- AcrylX™ applied acrylic surface
- 1 1/8" skirt
- Compliant when properly installed
- Center front drain outlet
- Integral front trench drain
- 5-year limited warranty
- 12" x 24" subway tile
- Slip resistant, textured bottom [ASTM F-462]

Int. Dim.	48 W x 36 D x 76 3/4 H
Ext. Dim.	54 W x 38 1/8 D x 78 3/4 H
Skirt Ht.	1 1/8 skirt
Packaged Wt.	170 lbs.
Material	AcrylX™ applied acrylic
Warranty	30-year warranty*

* See terms and conditions for details

inches

CONFIGURATION (handed by fixture wall)

- Shell reinforced for future accessory installation
Fixture wall LH RH Back wall
 Optional vertical bar reinforcement (entry wall)
 LH RH Both
- Fully configured
Fixture Wall (must choose one) LH RH Back Wall
Includes two stainless steel 28" x 1 1/2" grab bars located on the side wall and one stainless steel 36" x 1 1/2" grab bar located on the back wall
 Factory-installed plumbing options
 Hand-held shower assembly, 30" slide bar and 60" hose
 Pressure balancing mixing valve

OPTIONAL ACCESSORIES (available for all models)

- Stainless steel vertical bar 24" x 1 1/2" (entry wall)
 LH RH Both
- Large soap dish (12 1/2" W x 3 1/2" D x 1 1/2" H), shipped loose
- Small soap dish (7" W x 3 1/2" D x 1 1/2" H), shipped loose
- Curtain rod, shipped loose
- Shower curtain, shipped loose
- Brass drain
- Colors:
Standard White
Upgraded Biscuit Bone
 Other (contact customer service for custom color options)
- Additional accessories:

CUSTOM OPTIONS

- Grab bars:
 Horizontal U-shaped bars: 28" (side walls), 18" (back wall)
 Vertical bar 24" (entry wall) LH RH Both
- Grab Bar finish:
 Stainless steel (1 1/2" dia.)
 Powder-coated white (1 1/4" dia.)
- Factory-installed plumbing options
 Hand-held shower assembly, 30" slide bar and 60" hose
 Pressure balancing mixing valve
Fixture wall LH RH Back wall
- Grate:
 Stainless steel
 White
 Tamper-proof

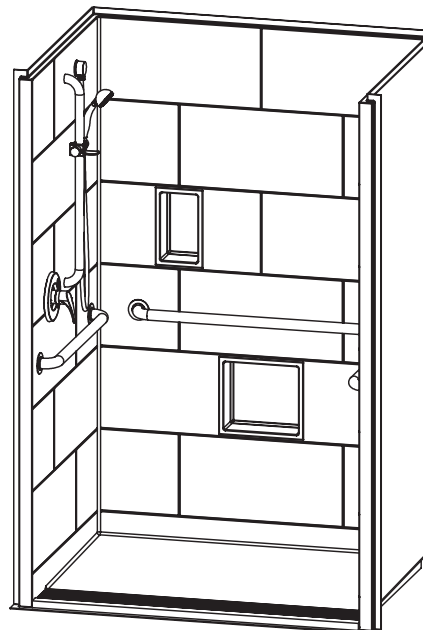

Left wall left fixture placement configuration shown with optional soap dish



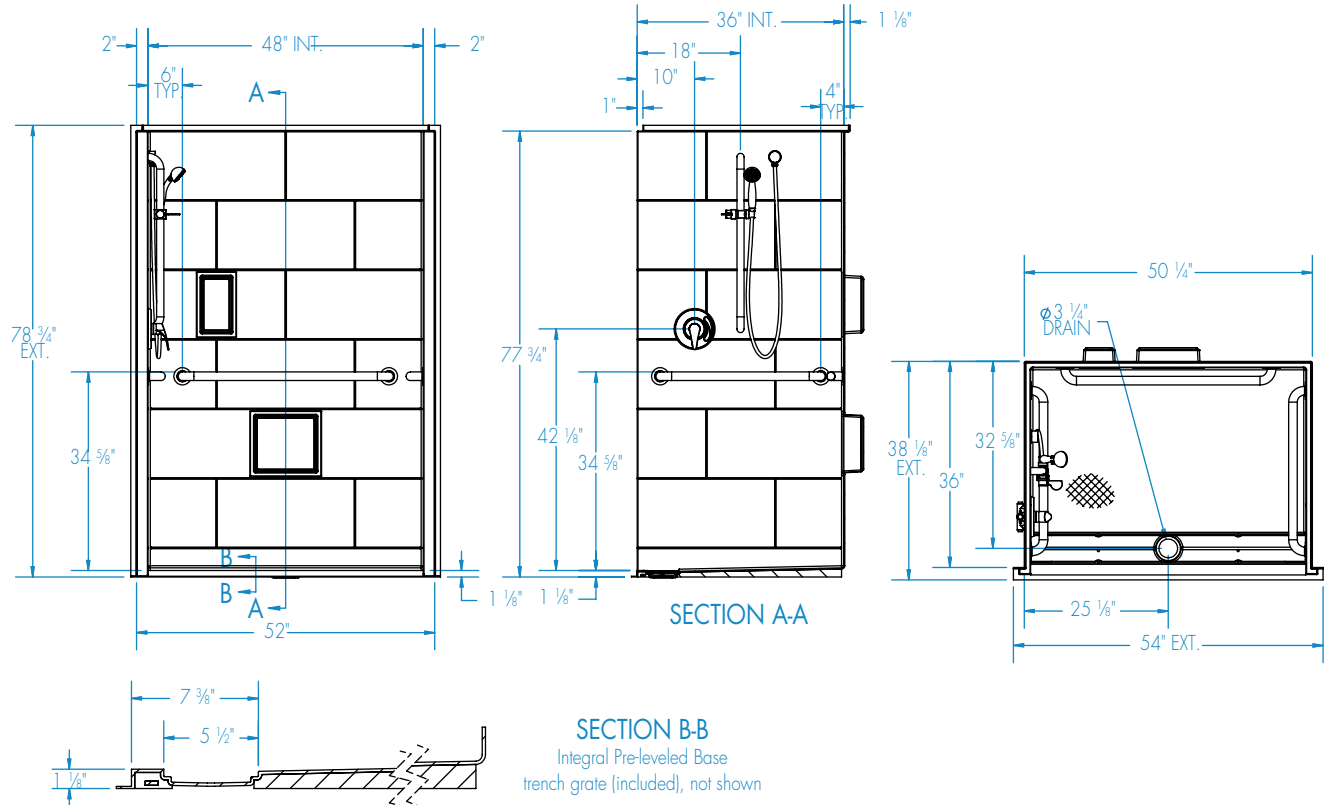

FEATURES lbs Dimensional Tolerance $\pm \frac{3}{16}$ ". Dimensions needed for site preparation should be measured from the unit. Manufacturer assumes no responsibility for preparatory work.

Type and Model #	Material	Wall Finish	Pieces	Drain	Dam/Skirt Height	Net Wt.	Pkg. Wt.
Shower HMT5038TR 1.125	AcrylX™ applied acrylic	Smooth tile	1	Center Front	1 1/8" skirt	160	170

DIMENSIONS

Specifications	inches (mm)
Width: Ext. / Int.	54 / 48
Depth: Ext. / Int.	38 1/8 / 36
Height: Ext. / Int.	78 3/4 / 76 3/4
Enclosure Opening:	48
Skirt Height:	1 1/8
Drain Rough-In (from Back Wall)	32 5/8
Drain Rough-In (from Side Wall)	25 1/8

FRAMING DIMENSIONS inches (mm)

Type	D Depth	W Width	H Height	A	B	C
Alcove	36	50 1/4	-	Box Out	25 1/8	32 5/8

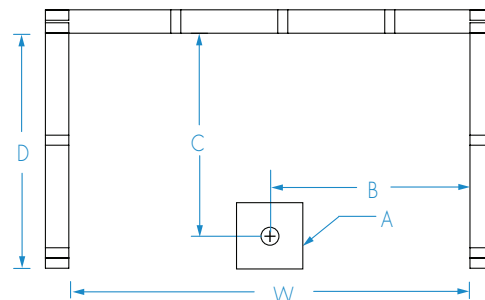

EMAIL TO THE CENTRALIZED CUSTOMER SERVICE CENTER: quotes@americanbathgroup.com